

BRITISH WOMEN WRITERS CONFERENCE

Fresh Threads of Connection

APRIL 2-5, 2009

April 2, 2009

LADIES AND GENTLEMEN,

Welcome to the seventeenth annual Eighteenth- and Nineteenth-Century British Women Writers Conference! After nearly two years of planning, we are delighted to host this beloved conference in Iowa City.

We stumbled upon the theme of this year's conference—"Fresh Threads of Connection"—in George Eliot's *Middlemarch*, at a point where she refers to the new affiliations that arose in provincial England, especially between towns and rural areas. While some connections, like the ones Eliot describes, are recognized and acknowledged by contemporaries, others, like the one depicted in our cover illustration, are more repressed and may quietly bind together entities that seem to be sharply and insistently divided. Picking up these threads, the aim of this conference is to stitch together similarly fresh connections in the study of eighteenth- and nineteenth-century British women writers—an aim that the papers to be presented this weekend will no doubt accomplish.

Indeed, we are extraordinarily grateful for your titanic response to our call for papers. Much as we were deluged with water last June during the historic flooding along the Iowa River, in October of last fall, we were knee-deep in enticing abstracts promising connections between British women writers and people, places, and things as far-flung as Osama bin Laden, Thailand, and modern computing. Because of this enthusiastic response, we have a line-up of tantalizing panels. In addition, we hope you will join us for the roundtable discussion—"Refreshing Conceptions of the Other," with scholars Misty Anderson, Florence Boos, Shuchi Kapila, and Devoney Looser—as well as for our keynote lectures with scholars Joy Sperling and Alison Booth. While you are here, we also hope you will take the time to visit our exhibit, "Fresh Threads of Connection: Mother Nature and British Women Writers," as well as to attend our Saturday evening event, called "Celebrating Victorian Women's Lives: An Evening of Music and Recitations," with an introduction by Judith Pascoe. Please find a fuller description of these two events on the following page in your program.

To help you plan accordingly, we lastly want to mention that moderators have been encouraged to begin panels promptly and to stop speakers after twenty minutes. Due to our full schedule and to our efforts to give you time in the evenings to relax and enjoy Iowa City, we will have to adhere as strictly as possible to the schedule, so please keep this in mind. Also, you will notice that the conference is taking place in several locations. The first and second are Hotel Vetro and the Sheraton, located on Iowa City's "ped mall." Our third location is the Old Capitol, the state of Iowa's first capitol building as well as our university's founding edifice. The adjacent map and our volunteer staff can help if you find yourself in need of directions.

Thank you again for joining us, and here's to a weekend full of connections—both scholarly and social!

All the best,
The BWWC 2009 Organizing Team

Laura Capp - - - - Bridget Draxler - - - - Lynne Nugent - - - - Anna Stenson - - - - LeDon Sweeney

MAP OF SHERATON, LOWER LEVEL

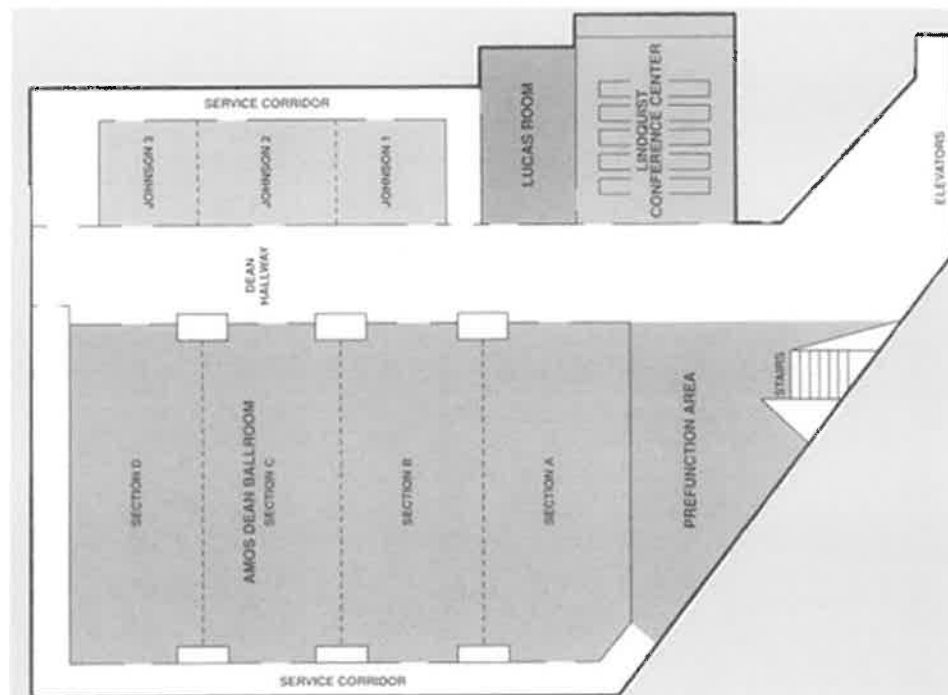

WALKING ROUTE FROM THE SHERATON TO OLD CAPITOL MUSEUM

Turn left as you exit the Sheraton north entrance. Proceed down the pedestrian mall and turn right at Clinton Street. Pass Washington Street and look for the gold dome on your left.

CONFERENCE SCHEDULE

WEDNESDAY, APRIL 1ST

6:00 p.m.-9:00 p.m. Registration Sheraton, Lower Level

THURSDAY, APRIL 2ND

7:45 a.m.-8:45 a.m. Continental Breakfast Sheraton, Lower Level
8:00 a.m.-4:30 p.m. Registration Sheraton, Lower Level
9:00 a.m.-10:15 a.m. Session 1 Old Capitol
10:30 a.m.-11:45 a.m. Session 2 Old Capitol
11:45 a.m.-1:00 p.m. Lunch on your own
1:00 p.m.-2:15 p.m. Session 3 Old Capitol
2:30 p.m.-3:45 p.m. Session 4 Old Capitol
4:00 p.m.-5:00 p.m. Welcome Reception Hotel Vetro, Ballroom
5:00 p.m.-7:00 p.m. Plenary Panel Hotel Vetro, Ballroom

FRIDAY, APRIL 3RD

8:00 a.m.-9:00 a.m. Continental Breakfast Sheraton, Lower Level
8:30 a.m.-4:30 p.m. Registration and Book Fair Sheraton, Lower Level
9:00 a.m.-10:15 a.m. Session 5 Sheraton, Lower Level
10:30 a.m.-11:45 a.m. Session 6 Sheraton, Lower Level
11:45 a.m.-1:00 p.m. Lunch on your own
1:00 p.m.-2:15 p.m. Session 7 Sheraton, Lower Level
2:30 p.m.-4:05 p.m. Session 8 Sheraton, Lower Level
4:30 p.m.-5:30 p.m. Reception Old Capitol
5:30 p.m.-7:00 p.m. Keynote: Joy Sperling Old Capitol, Senate Chamber

SATURDAY, APRIL 4TH

8:00 a.m.-9:00 a.m. Continental Breakfast Sheraton, Lower Level
8:30 a.m.-4:30 p.m. Registration and Book Fair Sheraton, Lower Level
9:00 a.m.-10:15 a.m. Saturday Seminars Sheraton, Lower Level
10:30 a.m.-11:45 a.m. Session 9 Sheraton, Lower Level
12:00 p.m.-2:00 p.m. Luncheon Hotel Vetro, Ballroom
Keynote: Alison Booth Hotel Vetro, Ballroom
2:15 p.m.-3:30 p.m. Session 10 Sheraton, Lower Level
3:45 p.m.-5:00 p.m. Session 11 Sheraton, Lower Level
5:00 p.m.-7:00 p.m. Dinner on your own
7:00 p.m.-9:00 p.m. Evening of Recitations, Introduced by Judith Pascoe Old Capitol, Senate Chamber

SUNDAY, APRIL 5TH

8:00 a.m.-9:30 a.m. BWWA Board Breakfast Sheraton, Lucas Board Room

SPECIAL EVENTS

“FRESH THREADS OF CONNECTION”: MOTHER NATURE AND BRITISH WOMEN WRITERS

“Fresh Threads of Connection: Mother Nature and British Women Writers” considers changing conceptions of nature within women’s literature in eighteenth- and nineteenth-century Britain. During this formative time in English history, developments in science and philosophy—from Enlightenment definitions of natural law to Darwinian theories of natural selection to philosophical reflections on the Sublime and the Beautiful—challenged popular perceptions of both what it meant to be “natural” and what it meant to be a woman. Women were often attributed the passive beauty and mystical power of nature, two qualities both prized and feared in a society built on rational thought and orderly process. This connection was both empowering and oppressive: women and nature were emblems of pure virtue and sources of tempestuous strife; they were confined by men, but proved themselves unrestrainable; they embodied humanity’s primitive past and symbolized society’s idealized future.

Taking its title from George Eliot’s novel *Middlemarch*, “Fresh Threads of Connection” features ten women writers and their unique relationships with nature and each other. The exhibit questions the art and nature of science in the works of Mary Shelley and Margaret Cavendish; it considers visions of human nature in the writings of Mary Wollstonecraft and Jane Austen; it celebrates the imaginative animal worlds of Anna Sewell and Beatrix Potter; it examines the cross-cultural and cross-disciplinary treatment of nature in works by Christina Rossetti and Lady Mary Wortley Montagu; it analyzes nature as an artistic metaphor in the novels of Charlotte Brontë and George Eliot. By exploring these authors’ unexpected connections in parallel with their literary treatment of nature, “Fresh Threads of Connection” reveals the complex yet intimate bond between Mother Nature and female artists in eighteenth- and nineteenth-century Britain. Women writers of this period embraced, revolted against, and ultimately propelled contemporary debates in both their literature and their lives, creating a legacy of nature-inspired feminist expression that continues to resonate today.

The exhibit is on display in the Humanities Gallery of the Old Capitol Museum. The University of Iowa Old Capitol Museum, The University of Iowa Museum of Art, and The University of Iowa Libraries Special Collections sponsored the exhibit, which was curated by Bridget Draxler, one of the graduate student organizers of the 2009 British Women Writers Conference.

CELEBRATING VICTORIAN WOMEN’S LIVES: AN EVENING OF MUSIC AND RECITATIONS

Calling all enthusiasts of Queen Victoria, British parlors, and poetry in performance! On Saturday, April 4th, 2009, at 7:00 p.m., The University of Iowa Department of English, the Department of Theatre Arts, the School of Music, and Prairie Lights Bookstore will join forces to present an event inspired by parlor recitations and home theatricals of the nineteenth century. The evening will highlight poetry and music written by Victorian women authors and composers and will be performed by a collection of faculty, graduate student, and undergraduate actors from the university and the Iowa City area. Professor Judith Pascoe from the Department of English will introduce the performance with a talk called “Hearing Voices.” The event will be held at the Senate Chamber of The University of Iowa’s historic Old Capitol building and is free and open to the public.

BRITISH WOMEN WRITERS CONFERENCE 2009

Hosted by The University of Iowa Department of English

WEDNESDAY, APRIL 1ST

Registration: 6:00 p.m.-9:00 p.m.—Sheraton, Lower Level

THURSDAY, APRIL 2ND

Continental Breakfast: 7:45 a.m.-8:45 a.m.—Sheraton, Lower Level

Registration: 8:00 a.m.-4:30 p.m.—Sheraton, Lower Level

Session 1: 9:00 a.m.-10:15 a.m.—Old Capitol Building

1A: Heaven, Hell, and High Water: Female Religion across Time and Space (Senate Chamber)

Moderator: Joanne Janssen, University of Iowa

- Julie Melnyk, University of Missouri: "Emma Jane Worboise's *Christian World Magazine*: Evangelicalism and Transnational Community"
- Janna Smartt Chance, Union University: "Fire, Brimstone, and Female Empowerment in the Anti-Oxford Movement Writings of Caroline Fry and Charlotte Elizabeth Tonna"
- Bethany Bear, Baylor University: "'Earth grown wild, yet still so green': The End of Time in Christina Rossetti's Advent Poems"

1B: Claims to Power: Authorship and Authority (Supreme Court)

Moderator: Stacy Erickson, Manchester College

- Sylvia A. Brown, Denison University: "Conjuring Narrative Authority in Eliza Haywood and George Eliot"
- Anca Vlasopolos, Wayne State University: "Talking Back to Trollope: Reinventing the Woman Writer in the Fin de Siècle"

1C: Dramatis Personae (History Gift Shop)

Moderator: Robin Anglin, Indiana University

- Tracey Metivier, Indiana University: "The Closet of Epistemology: The De-Conventional Theatricality of Joanna Baillie"
- Melissa Sodeman, Coe College: "Mary Robinson at the Limits of Sentimental Cliché"
- Laura Wallace, The City College of the City University of New York: "Marian Erle, or Only an Actress? The Poetess' Patronage of a Fallen Female Art in *Aurora Leigh*"

Session 2: 10:30 a.m.-11:45 a.m.—Old Capitol Building

2A: Weaving Together History and Fiction (Senate Chamber)

Moderator: Charles H. Hinnant, University of Missouri—Columbia

- Cynthia Huff, Illinois State University: "Cross-stitches of the family: Familial discourse in *Wuthering Heights* and the Victorian diary"
- Margaret Enright Wye, Rockhurst University: "Naval Architecture in *Persuasion*: Jane Austen's Artful Use of Frank Austen's Navy Career"
- Deborah Denenholz Morse, College of William and Mary: "Mutiny on the Orion: The Legacy of the Hermione Mutiny and the Politics of Nonviolent Protest in Elizabeth Gaskell's *North and South*"

2B: Leading Ladies (Supreme Court)

Moderator: Nicole Lobdell, University of Georgia

- Kathy Nixon, American University of Kuwait: "Beatrice is no saint: Feminist Medievalism and Gender Role Renegotiations in Catherine Sinclair's *Beatrice or the Unknown Relatives*"
- Michelle Mouton, Cornell College: "'A Colony of Little Pensioners': Ageism and Multigenerational Conflict in Margaret Oliphant's *Hester*"
- Melissa Purdue, Minnesota State University, Mankato: "Anne on the Lam: Rosa Campbell Praed's Lost-Race Novel *Fugitive Anne: A Romance of the Unexplored Bush*"

2C: Private Women in Public Places (History Gift Shop)

Moderator: Barbara Britton Wenner, University of Cincinnati

- Heather Love, Indiana University: "Dramatizing the Emergence of the Bourgeois Public Sphere: Mary Pix's *The Beau Defeated; or, The Lucky Younger Brother*"
- Katherine Anderson, Indiana University: "'A Kind of Forced Plant': Girls and Gardens in the Metropolis"
- Kate Krueger Henderson, College of Saint Catherine: "A 'Passed' Encounter: Sisterhood and Urban Space in Charlotte Mew's London"

Lunch on your own: 11:45 a.m.-1:00 p.m.

Session 3: 1:00 p.m.-2:15 p.m.—Old Capitol

3A: Wandering Women and Cosmopolitan Connections (Senate Chamber)

Moderator: Miranda Yaggi, Indiana University

- Manushag N. Powell, Purdue University: "Pirates in Romance / Cosmopolitan Maidens"
- Linda Mills Woolsey, Houghton College: "'All the Ties She Had Broken Pressed Upon Her Bosom': Sidney Owenson and the Riddle of Connections in *The Missionary An Indian Tale* (1811)"
- Julia McCord Chavez, Marquette University: "Rooted Wandering and Transcultural Connection in George Eliot's *Daniel Deronda*"

3B: I Can't Fight This Feeling: Gendered Emotions and the Gothic Genre (Supreme Court)

Moderator: Amanda Drake, University of Nebraska-Lincoln

- Dawn Nawrot, University of Wisconsin-Milwaukee: "Emotional Control, Transgression, and Gender in *The Mysteries of Udolpho*"
- Elizabeth Murray, Ball State University: "'I Have Sacrificed Myself to a Romantic Feeling': Sarah Wilkinson's Critique of the Rational Woman in *The Spectre of Lannere Abbey*"
- Ashly Bennett, Cornell University: "Shame and Sensibility: Jane Austen's Humiliated Heroines"

3C: Tying the Knot or Tied up in Knots: The New Matrimony (History Gift Shop)

Moderator: Janet Reed, University of Cincinnati

- Amy L. Gates, University of Illinois at Chicago: "Glanville Learns to Read: Interpretation and Understanding in *The Female Quixote*"
- Erin Spinka, Vanderbilt University: "The Murdering Professions: Medicine and Marriage in Eliot's *Middlemarch*"
- Donna Decker, Franklin Pierce University: "Are You My Mother? Genesis of New Woman Fiction Reexamined"

Session 4: 2:30 p.m.-3:45 p.m.—Old Capitol

4A: Women of Letters: Female Correspondents (Senate Chamber)

Moderator: Troy J. Bassett, Indiana University-Purdue University Fort Wayne

- Stacy Erickson, Manchester College: "'As to that Lady that wrote the Romancy': Aphra Behn's Nostalgic Self-Authorization"
- Mandy Gagel, University of Virginia: "Vernon Lee's Early Letters: The Author's Search for Mentors Among Contemporary Female Authors"
- Nicole Lobdell, University of Georgia: "Complex Letters: Mary Hays, Jane Austen, and the Discourses of Masculine Correspondence"

4B: Romantic Entanglements: Courtship Gone Awry (Supreme Court)

Moderator: Taryne Jade Taylor, University of Iowa

- Tembi Bergin-Batten, University of Iowa: "'Extremely on Her Guard': Ravishment, Power and Politeness in *The Female Quixote*"
- Charles H. Hinnant, University of Missouri—Columbia: "Elizabeth Griffith's *The Delicate Distress*: Sentimental or Amatory Novel?"
- Tamar Heller, University of Cincinnati: "Rewriting *Corinne*: Female Autonomy and Literary Revision in Rhoda Broughton's *Good-Bye, Sweetheart!*"

4C: Victorian Women Rewriting Shakespeare (History Gift Shop)

Moderator: Melissa Sodeman, Coe College

- Erin Breaux, Louisiana State University: "Educating Victorian Readers and Families: Mary Cowden Clarke's *The Childhoods of Shakespeare's Heroines*"
- Laura Keigan, Louisiana State University: "Ministering Angels: Philanthropy as Active Femininity in Anna Jameson's *Shakespeare's Heroines*"
- Doris Raab, Louisiana State University: "Gender and Blame: Amelia Opie's Adaptation of *King Lear*"

Welcome Reception: 4:00 p.m.-5:00 p.m.—Hotel Vetro, Ballroom

Plenary Panel: 5:00 p.m.-7:00 p.m.—Hotel Vetro, Ballroom

"REFRESHING CONCEPTIONS OF THE OTHER"

Misty Anderson, University of Tennessee-Knoxville

Florence Boos, University of Iowa

Shuchi Kapila, Grinnell College

Devoney Looser, University of Missouri-Columbia

Sponsored by The University of Iowa College of Liberal Arts and Sciences' Perry A. and Helen J. Bond Fund for Interdisciplinary Interaction and The University of Iowa Graduate College

FRIDAY, APRIL 3RD

Continental Breakfast: 8:00 a.m.-9:00 a.m.—Sheraton, Lower Level

Registration: 8:30 a.m.-4:30 p.m.—Sheraton, Lower Level

Book Fair: 8:30 a.m.-4:30 p.m.—Sheraton, Lower Level

Session 5: 9:00 a.m.-10:15 a.m.—Sheraton, Lower Level

5A: Socializing Sympathy in George Eliot (Ballroom A)

Moderator: Constance M. Fulmer, Pepperdine University

- Gretchen Hammerschmidt, University of Wisconsin-Madison: "Post-What?: Why George Eliot's *Middlemarch* has an Answer for Critics of Liberalism"

- Calina Ciobanu, Duke University: "Alternative Forms of Exchange: Intangible Gifts and Affective Debt in George Eliot's *Daniel Deronda*"
- Anna Neill, University of Kansas: "Suspended Animation and Second Sight in *Daniel Deronda* and *The Lifted Veil*"

5B: Scripting New Spaces: Recovering and Reconstructing Female Identity in the Long Nineteenth Century (Ballroom B)

Moderator: Cynthia Huff, Illinois State University

- Sarah K. Schwab, Saint Louis University: "Literary Intersections: Influence and Identity in *The History of Miss Betsy Thoughtless* and *The Female Quixote*"
- Lynn M. Linder, Saint Louis University: "Dueling Diaries: Male and Female Perspectives and Dinah Craik's *A Life for a Life*"
- Lisieux Huelman, Saint Louis University: "Professional Inheritance, Personal Identity: Performing New Female Scripts in *Wives and Daughters*"

5C: All in the Family: Incestuous Family Ties (Ballroom C)

Moderator: Sally Brooke Cameron, University of Notre Dame

- Anna Gibson, Duke University: "Weaving the Golden Cord: The Brother-Sister Bond and Gender Divisions in Nineteenth-Century Women's Writing"
- Deborah Manion, University of Iowa: "'The Seen and Unseen': Psychoanalytic Connections in Margaret Oliphant's 'The Portrait'"
- Sarah E. Kersh, Vanderbilt University: "Triangulations of Intimacy: Michael Field's *Whym Chow, Flame of Love*"

5D: Middle-Class Treasures: Establishing Respectability through Commodities (Ballroom D)

Moderator: Joel Haefner, Illinois Wesleyan University

- Joyce Kelley, Auburn University, Montgomery: "'Riveted to it until marriage': The Victorian Woman and the Piano"
- Deirdre McMahon, Drexel University: "Tea, Gender, and Middle-Class Tastes"
- Mary Jeanette Moran, College of Staten Island/CUNY: "New Kinds of Treasure: E. Nesbit's Bastables Seek Their Class"

5E: The Politics of Plumage: Textiles and the Text (Lindquist Room)

Moderator: Sukanya Gupta, Louisiana State University

- Sara R. Danger, Valparaiso University: "Bonnets and Politics: Domesticity and the Political Gaze in Frances Trollope's *Domestic Manners of the Americans*"
- Christie Peterson, Brigham Young University: "'The Home I Had Never Had': Imperialism and Domesticity in *The Professor*"
- Faith Wilson Stein, University of Illinois, Urbana-Champaign: "The Blue and the Pink, or the Textile and Textual Ties of Modern Subjects in *North and South*"

5F: The Geography of Gender: Mapping Textual Spaces (Johnson Room)

Moderator: Manushag N. Powell, Purdue University

- Bradley Spaulding, Indiana Wesleyan University: "Ecological (Dis)embodiment: Aphra Behn's *Oroonoko*, Eroticism, and Spectacular Violence"
- Barbara Britton Wenner, University of Cincinnati: "Late 18th-Century Feminine Picturesque in Africa: Anna Maria Falconbridge and Miss Tully"
- Deborah Pfuntner, Texas A&M University: "The Mental Map of North in Gaskell's *North and South*"

Session 6: 10:30 a.m.-11:45 a.m.—Sheraton, Lower Level

6A: Rewriting Literary Traditions: Adaptation and Translation (Ballroom A)

Moderator: Mary Ann O'Farrell, Texas A&M University

- Hyun-Jin Lim, University of Missouri-St. Louis: "From Pygmalion to Faust: Rewriting Formulas of Male Empowerment in Charlotte Dacre's *Zofloya*"
- Sarah Barber, University of Missouri: "Fathers and Daughter-Texts: Mary Cowden Clarke's *The Girlhood of Shakespeare's Heroines*"
- Hanna A. Jan, Kansas State University: "A Text Between Two Cultures: Problems of Translation in the Arabic Version of *Jane Eyre*"

6B: The Pleasure of Self and Pleasuring Oneself (Ballroom B)

Moderator: Beth Shane, University of Iowa

- Mary Beth Tegan, Saint Xavier University: "Vanity's Heirs: Maria Edgeworth, *Leonora*, and the Reformed Passions of Rousseau's *Julie*"
- Sarah Alexander, University of Illinois, Urbana-Champaign: "The Pleasure Problem: The Female Cyclist in New Woman Fiction"
- Rachel Slivon, University of Florida: "Irigarayan Seeds: Complex Women and Fetish Objects in George Egerton's 'A Little Grey Glove'"

6C: Politics of the Pen (Ballroom C)

Moderator: Janna Smartt Chance, Union University

- Susan B. Egenolf, Texas A&M University: "The Political Woman in Lady Morgan's *The O'Briens and the O'Flahertys* and *The Princess, or, The Beguine*"
- Taryne Jade Taylor, University of Iowa: "*New Amazonia*: Proto-Feminist Utopia or Dystopic Warning?"

6D: Collecting Women, Women Collecting (Ballroom D)

Moderator: Eugenia Gonzalez, The Ohio State University

- Jacqueline Grainger, Chawton House Library: "Fresh Threads of Connection at Chawton House Library"

- Celia Barnes Rasmussen, Indiana University: "'Revisal' of ones past life': Hester Piozzi and the Autobiographical Foul Copy"
- Pamela Corpron Parker, Whitworth University: "Elizabeth Gaskell's Autograph Collection and Female Celebrity"

6E: The Empire's New Clothes (Lindquist Room)

Moderator: Joyce Kelley, Auburn University, Montgomery

- April Pelt, University of Delaware: "The Fabrication of Englishness in *Jane Eyre*"
- Katie Sawhill, Piedmont College: "The Quaker and the Queen: A Showcase and Analysis of Two Remarkable Victorian Wardrobes"
- Elizabeth Erbezniak, University of Texas at Austin: "'He Wore Me Like a Silken Knot': Connecting Christina Rossetti, Fashion, and the Fallen Woman"

6F: In the Shadow of Famous Men (Johnson Room)

Moderator: Donna Parsons, University of Iowa

- Melisa Klimaszewski, Drake University: "Eliza Griffiths and Anonymous Power"
- Andrew Fippinger, Indiana University: "Getting Out from Wilde's Shadow: Reconsidering Ada Levenson's Fin-de-Siècle Sketches and Stories"
- Kevin Moberly, St. Cloud State University: "Punchcard Positivism: Ada Lovelace and the Nineteenth Century, as Programmed by Contemporary Culture"

Lunch on your own: 11:45 a.m.-1:00 p.m.

Session 7: 1:00 p.m.-2:15 p.m.—Sheraton, Lower Level

7A: Mommy Dearest (Ballroom A)

Moderator: Joshua Gooch, University of Iowa

- Meghan L. Burke, The Ohio State University: "The Ties that Bind: Contaminating Maternal Transmissions in Hays's *Memoirs of Emma Courtney*"
- Brooklynn L. Lehner, Illinois State University: "What Bad Mothers Can Teach Us: The Benefits of Bad Mothering in *Jane Eyre*"
- Elizabeth Talafuse, Texas A&M University: "Monstrous Motherhood in the Late-Victorian Works of Lucy Lane Clifford"

7B: Risky Business: Marital Speculations (Ballroom B)

Moderator: Deborah T. Meem, University of Cincinnati

- Jodi L. Wagner, Marian University: "Gambling and Chance in Nineteenth-Century British Literature: An Examination of Ann Radcliffe, Emily Brontë, and George Eliot"

- Annette Van, University of North Carolina at Greensboro: "Oliphant's *Hester* and the End of the Female Bildungsroman?"
- Lisa Hager, Georgia Institute of Technology: "Speculating on the New Woman: Connecting the Stock Exchange and the Marriage in Ella Hepworth Dixon's *My Flirtations*"

7C: National Identity and National Difference (Ballroom C)

Moderator: Elizabeth A. Raschke, Loras College

- Mary Lynn Johnson, University of Iowa: "The Tightly Networked Outsider: Cultural Interweavings of Mme de la Fite"
- Lanya Lamouria, Albion College: "Charlotte Brontë's *Villette*: The French Connection"
- Anne Longmuir, Kansas State University: "The French Connection: Understanding the Role of Belgium in Charlotte Brontë's *The Professor* and *Villette*"

7D: Unraveling Doppelgangers, Knitting Martyrs: Chaos & Pattern in Genre Classification (Ballroom D)

Moderator: Nancy M. West, University of Missouri-Columbia

- Rebecca Roma, University of Missouri-Columbia: "The Uncanny Case of *The History of Ophelia*: Sarah Fielding's Anomalous Premonition and the Nascent Gothic Novel"
- Caitlin L. Kelly, University of Missouri-Columbia: "An Assault on the Body: Social Dangers in *Northanger Abbey*"
- Karen Laird, University of Missouri-Columbia: "*Blessed Are They Who Mourn*: Felicia Hemans's Book of Martyrs"

7E: Reclaiming the Domestic: Finding Feminism in Tradition (Lindquist Room)

Moderator: Julie Melnyk, University of Missouri

- Sarah Wernsing, University of Northern Colorado: "'Other Nondescripts': Charlotte Yonge's Negotiation of Gender and Domestic Labor"
- Heather Edwards, University of Notre Dame: "Rosa Mulholland Gilbert and the Reconfiguration of Emancipation and the Domestic Sphere"
- Brenda J. Powell, University of St. Thomas: "Mary Chudleigh, the Women's Mosque Movement, and Docile Agency"

7F: Teutonic Shifts: The Influence of German Aesthetics (Johnson Room)

Moderator: Paul McCullough, University of Iowa

- Lindsey M. P. Gay, University of Colorado at Boulder: "Decrying Female Agency: Lady Wallace's Indictment of Womanhood through *Werther's* Charlotte"
- Michael T. Williamson, Indiana University of Pennsylvania: "'Speechless Horror to Congeal the Heart': Felicia Hemans, *The History of the Art of Antiquity*, and German Aesthetic Criticism"
- Kara M. Ryan, Tulsa Community College: "Aesthetics and Politics, Women and History: George Eliot's Critical Theory"

Session 8: 2:30 p.m.-4:05 p.m.—Sheraton, Lower Level

8A: Restoring Antiques: Reconnecting with Ancient Texts (Ballroom A)

Moderator: Kelly E. Battles, Maryville College

- Hyson Cooper, Temple University: "Gathering Edelweiss in Hades: Ouida's Revision of Classic Myth"
- Linda K. Hughes, Texas Christian University: "Discoursing of Xantippe: Amy Levy's 'Xantippe' and Classical Scholarship"
- Glenn Davis, St. Cloud State University: "Memory and Dissent in Ann Hawkshaw's *Sonnets on Anglo-Saxon History*"

8B: Re-Envisioning Texts: Innovative Responses, Intersections, and Juxtapositions (Ballroom B)

Moderator: Florence Boos, University of Iowa

- Patricia Murphy, Missouri Southern State University: "Closing the Gaps of *The Moonstone* in *The Danvers Jewels*"
- Kristine Swenson, Missouri University of Science and Technology: "Pet Causes: Rewriting Collins in Arabella Kenealy's Vivisection Novels"
- Anne McKee Stapleton, University of Iowa: "New Drawn Frae the Forth": The Compelling Voices of the Newhaven Fishwives"
- Donna Parsons, University of Iowa: "A Music Drama of Our Own: Wagnerian Influences in Michael Field's *Anna Ruina*"

8C: Passages to India (Ballroom C)

Moderator: Pamela Corpron Parker, Whitworth University

- Amishal Modi, Texas A & M: "The 'Making' of Maggie's Fallen Skin: The Transformation of a White Girl into a Brown Demon in George Eliot's *The Mill on the Floss*"
- Sharleen Mondal, University of Washington: "Reproducing the 'Pure' Nation: Celibacy in Sarah Grand's *The Heavenly Twins* and Bankimchandra Chattopadhyay's *Anandamath*"
- Julie Straight, Northwest Nazarene University: "Devout Hindus and English Idolators: Elizabeth Hamilton's *Letters of a Hindoo Rajah* and the British Missionary Movement"
- Sukanya Gupta, Louisiana State University: "Multivalent Connections & Interactions: the Englishwoman and India"

8D: Drugs, Doctors, and Disease: Medicine and Literature (Ballroom D)

Moderator: Meagan Timney, Dalhousie University

- Kathleen Béres Rogers, College of Charleston: "'Ye Sage Physicians, Where's Your Wonted Skill?': Interrogating Medicine in Jane Cave Winsom's *Headache Odes*"

Lorna Wiedmann, Wisconsin Lutheran College: "Chloroform Hydrate Habitués and their 'Wounded-Healer' Wonder: Florence Nightingale, Friedrich Nietzsche, Bram Stoker, Edith Wharton, William James, and Bertha Pappenheim"

- Nancy Cervetti, Avila University: "The Case of Rosamond Vincy and the Ideal Wife"

8E: What Is a Woman To Do?: Female Duties and Vocations (Lindquist Room)

Moderator: Donna Decker, Franklin Pierce University

- Abigail Burnham Bloom, Hunter College, NY: "The New Woman and the Old Morality of Duty"
- Lacie Osbourne, Texas A & M: "I will see him in the library": Shattering the Angel Role in the Drawing Room in *Middlemarch*"
- Carter Hanson, Valparaiso University: "Like a Good Neighbor: Three Emigrant Gentlewomen's Encounters in Canada, 1830-1870"

8F: Literary Nation-Building (Johnson Room)

Moderator: H. Michael Buck, Indiana Wesleyan University

- Sally B. Palmer, South Dakota School of Mines and Technology: "Divisive Connections: Personal and Political Rivalry in Jane Austen"
- April N. Kendra, University of North Texas: "Mrs. Gore Writes Back: The Fight for the English National Drama"
- Kelly Payne, University of Nebraska-Lincoln: "'A puerile state of culture': Growing Pains and Culture Shock in *Daniel Deronda*"
- Carrie Dickison, University of Illinois, Urbana-Champaign: "'In-between Spaces': Travel Writing and Owens' National Tale"

Reception: 4:30 p.m.-5:30 p.m.—Old Capitol Building

Keynote: 5:30 p.m.-7:00 p.m.—Old Capitol, Senate Chamber

"THE TOURIST VIEW: VICTORIAN WOMEN ABROAD"

Joy Sperling, Denison University

Sponsored by the Old Capitol Museum and The University of Iowa Museum of Art

SATURDAY, APRIL 4TH

Continental Breakfast: 8:00 a.m.-9:00 a.m.—Sheraton, Lower Level

Registration: 8:30 a.m.-4:30 p.m.—Sheraton, Lower Level

Book Fair: 8:30 a.m.-4:30 p.m.—Sheraton, Lower Level

Saturday Seminars: 9:00 a.m.-10:15 a.m.—Sheraton, Lower Level
Pre-registration is required for participation in the Saturday Seminars.

Seminar 1: Undergraduate Research and the Case of Mary Peach Collier (Ballroom A)

Join Murray State University Professor Kevin Binfield and two of his undergraduate students, Angela Hatton and Angela Walther, as they discuss how they tackled an ambitious undergraduate research project (complete with a trip to London) on author Mary Peach Collier and how we might make such initiatives more possible for undergraduate research in the humanities.

Seminar 2: *Beachy Head*: Fresh Threads for the Classroom (Ballroom B)

Distinguished professor, poet, and founding member of the British Women Writers Association, Donelle Ruwe from Northern Arizona University will lead us in a discussion of Charlotte Smith's poem. Professor Ruwe has edited a collection of essays for the *Children's Literature Association, Culturing the Child 1660-1830: Essays in Memory of Mitzi Myers* (Scarecrow Press 2005) and is the editor of special issues of *Religion and Literature* and *Nineteenth-Century Contexts*. Ruwe is also a published poet and the recipient of two chapbook awards.

Seminar 3: Stitching Action into the Classroom (Ballroom C)

The seminar will explore how, as instructors, we might incorporate community outreach and action into the learning experience that a classroom provides. It will be led by Teresa Mangum—recipient of the University of Iowa's President and Provost Award for Teaching Excellence and co-director of Iowa's Obermann Graduate Institute for Public Engagement—as well as Joanne Janssen and Bridget Draxler, past fellows of the Obermann Institute, and Jessica DeSpain, an assistant professor at Southern Illinois University Edwardsville.

Seminar 4: *The Tenant of Wildfell Hall*: Fresh Threads for the Classroom (Ballroom D)

If you long for the days of graduate seminars and a spirited discussion of a good book, look no further! University of Iowa's James O. Freedman Professor of Letters Garrett Stewart will lead the group through a discussion of Anne Brontë's novel. The reading for the seminar will be taken from Professor Stewart's most recent book, *Novel Violence: a Narratology of Victorian Fiction*, due in the spring from the University of Chicago Press.

Seminar 5: Journal-Bound: The Seamless Transition from Manuscript to Print (Lindquist Room)

For anyone who has fretted about the publishing process, Alvin Snider, editor of the University of Iowa's *Philological Quarterly*, and Sarah Theobald-Hall, managing editor of *Tulsa Studies in Women's Literature*, will discuss their advice about revising manuscripts for publication from an editorial perspective as well as the dos and don'ts of submitting articles. Come with your questions!

Session 9: 10:30 a.m.-11:45 a.m.—Sheraton, Lower Level

9A: Literary Legislation (Ballroom A)

Moderator: Marty Gould, University of South Florida

- Constance M. Fulmer, Pepperdine University: "Threads of Connection Between Victorian Women and Women of the Ancient East: Edith J. Simcox's Primitive Civilizations"
- Kellie Holzer, University of Washington: "Bad Laws and Blood Ties: Remarriage and Incest in 19th Century England and India"

9B: Reinterpreting the Romantics (Ballroom B)

Moderator: Sally B. Palmer, South Dakota School of Mines and Technology

- Chantelle (Jacobs) Messier, University of Connecticut: "'Indecent hearts' in the Reformist England of *Aurora Leigh*"
- Helen Luu, Trent University: "Mending Severed Threads: Augusta Webster and Felicia Hemans"
- Anna Fenton-Hathaway, Northwestern University: "Imagining Backward, Imagining Forward: Victorian Poetics of Aging"

9C: Rewriting the Past: Historical Fictions (Ballroom C)

Moderator: Brenton Thompson, University of Iowa

- H. Michael Buck, Indiana Wesleyan University: "Birthing the Historical Novel: A New Connection Between Jane Austen and Walter Scott's *Waverley*"
- Kelly E. Battles, Maryville College: "George Eliot's *Romola* and the Dignity of History: A Different Kind of Historical Novel"
- Kara Marler-Kennedy, Rice University: "History and Social Memory in Elizabeth Gaskell's *Sylvia's Lovers*"

9D: Domesticating Objects (Ballroom D)

Moderator: Mary Lynn Johnson, University of Iowa

- Eugenia Gonzalez, The Ohio State University: "Strange Bonds of Sympathy: *Girls and Dolls in the Victorian Short Story*"
- Jessica Durgan, Texas A&M University: "The Colonial Object and the Domestic Novel: India and Empire in Charlotte Yonge's *Countess Kate*"
- Joel Haefner, Illinois Wesleyan University: "Living with the Machines: Gender and Domestic Technology in Late Victorian and Edwardian Britain"

9E: Apart at the Seams: Series, Volumes, and Textual Interruptions (Lindquist Room)

Moderator: Emily Friedman, University of Missouri

- Melissa M. Donegan, University of Iowa: "From Epigraph to Epitaph: Memory and Memorial in Elizabeth Gaskell's *Mary Barton*"

Carol Hanbery MacKay, University of Texas at Austin: "Reconnecting the Interrupted Serial: Ann^ul Thackeray Ritchie's *Mrs. Dymond* Over Time and Space"

Troy J. Bassett, Indiana University-Purdue University Fort Wayne: "Edging Women Out?: Women Authors, and the Three-Volume Novel, 1840-1895"

9F: Science in the Drawing Room (Johnson Room)

Moderator: Kathleen Béres Rogers, College of Charleston

- Kyoko Takanashi, Indiana University: "Narrative Space in Railroad Time"
- Anne Chandler, Southern Illinois University-Carbondale: "Maria Edgeworth's Darwinian Feminism: Mixed Messages in *Practical Education*"

Keynote Luncheon: 12:00 p.m.-2:00 p.m.—Hotel Vetro, Ballroom

"RECOVERY 2.0: EXHIBITING WOMEN'S COLLECTIVE BIOGRAPHIES"

Alison Booth, University of Virginia

Sponsored by The University of Iowa's International Programs, the Eighteenth and Nineteenth Century Interdisciplinary Colloquium, and The University of Iowa Graduate College

Congratulations to this year's recipients of the BWWA's Graduate Student Travel Awards!

- Meghan L. Burke, The Ohio State University: "The Ties that Bind: Contaminating Maternal Transmissions in Hays's *Memoirs of Emma Courtney*"
- Lynn Cowles, University of Texas at Austin: "'From the horizon truth's broad mirror gleams': The Royal Navy and Subjectivity of Perspective in Eighteenth-Century British Women Poets' Progression into the Public Sphere"
- Nandini Sengupta, Syracuse University: "The British Woman Traveler in India: Narratives of Colonial Intimacy"

Session 10: 2:15 p.m.-3:30 p.m.—Sheraton, Lower Level

10A: Desiring Women: Homoerotic Bonds in the Fin-de-Siècle (Ballroom A)

Moderator: Lisa Hager, Georgia Institute of Technology

- Deborah T. Meem, University of Cincinnati: "What 'one woman could be to another': Linton and Johnstone setting the terms in the 1880s and 90s"
- Diana E. Bellonby, Vanderbilt University: "Queerness in Pieces: The Story of Venus in Michael Field's *Sight and Song*"
- Sally Brooke Cameron, University of Notre Dame: "'We are Closer Married': Michael Field's *Sight and Song* and Sexual / Textual Bonds Between Women"

10B: British Women Abroad: To the Ends of the Empire and Beyond (Ballroom B)

Moderator: Amit Baishya, University of Iowa

- Nandini Sengupta, Syracuse University: "The British Woman Traveler in India: Narratives of Colonial Intimacy"
- Paula Reiter, Mount Mary College: "The Ties That Bind"

10C: Fashionable Threads (Ballroom C)

Moderator: Mary Beth Tegan, St. Xavier University

- Megan Early Alter, University of Iowa: "The Legacy of *Tom: The Half Sisters* and *The Victims of Society*"
- Molly Engelhardt, Texas A&M University—Corpus Christi: "'Passionately Fond of Dancing': Maternal Connections in Catherine Gore's *The Debutante*"
- Cheryl A. Wilson, Indiana University of Pennsylvania: "Gender, Fashion, and Social Power in *Emma*"

10D: Contracting Community (Ballroom D)

Moderator: Mary Jeanette Moran, College of Staten Island/CUNY

- Joshua Gooch, University of Iowa: "'No Phantasm of Delight': Disruptions of Social and Economic Production in George Eliot's *Silas Marner*"
- Sharon M. Twigg, Johnson State College: "The Labors of Mediating Contract in Elizabeth Gaskell's *Mary Barton*"
- Meagan Timney, Dalhousie University: "Working-Class Women's Communities in the Nineteenth-Century Periodical Press"

10E: Raising Britain: Education Techniques and Reforms (Lindquist Room)

Moderator: Jodi L. Wagner, Marian University

- Donelle Ruwe, Northern Arizona University: "'Will you go abroad?': Parenting and Poetics in Barbauld and Trimmer"
- Cecily Hill, University of Southern Mississippi: "Composing *Jane Eyre*: Ellenor Fenn, Mary Lamb and the Making of a Governess"
- Janis Dawson, University of Victoria: "L. T. Meade's *Atalanta*: 'Far away the best magazine for girls in existence, and not for girls alone, but for anyone who can relish really good literature'"

10F: Illustrating Women (Johnson Room)

Moderator: Carol Hanbery MacKay, University of Texas at Austin

- Gina Opdycke Terry, Texas A&M University: "L.E.L.'s 'Poetical Illustrations': Reconnecting Text and Image in the Literary Annuals"
- JoAnna Stephens Mink, Minnesota State University, Mankato: "The Influence of Women Illustrators on Readers of Nineteenth-Century Novels"
- Ruth Hoberman, Eastern Illinois University: "Gender and Representation in 1890s Fiction by Vernon Lee and May Sinclair"

Session 11: 3:45 p.m.-5:00 p.m.—Sheraton, Lower Level

11A: Sewing Self-Expression: Cross-Stitching and Cross-Dressing (Ballroom A)

Moderator: Elizabeth Erbeznik, University of Texas at Austin

- Corey Goergen, University of Georgia: "The Fate of Rogues': Contagious 'Freke'-ness in Maria Edgeworth's *Belinda*"
- K. Irene Rieger, Case Western Reserve University: "The Thread is Lost: Female Solidarity and the Making and Exchanging of Clothing in Iota's *A Yellow Aster*"
- Christine Bayles Kortsch, Eastern University: "A Needle Dipped in Blood: Dual Literacy in Elizabeth Parker's Sampler and Olive Schreiner's *From Man to Man*"

11B: Single but Not Solitary (Ballroom B)

Moderator: April N. Kendra, University of North Texas

- David Frank Jakalski, University of Illinois at Chicago: "Promising Politics in Amelia Opie's *Adeline Mowbray*"
- Sandra Hagan, Vancouver Island University: "Untying the Knot: Charlotte Brontë and Amy Levy Co-Write a Happy Ending for Single Women in *Villette* (1853) and *The Romance of a Shop* (1888)"
- Sharon Smith Palo, North Iowa Area Community College: "The Ties that Bind': Gender, Property, and the Threads of Narrative in Sarah Scott's *Millennium Hall*"

11C: Literature at War (Ballroom C)

Moderator: Susan B. Egenolf, Texas A&M University

- Lynn Cowles, University of Texas at Austin: "From the horizon truth's broad mirror gleams': The Royal Navy and Subjectivity of Perspective in Eighteenth-Century British Women Poets' Progression into the Public Sphere"
- Mary Ann O'Farrell, Texas A&M University: "The Writings of Osama bin Austen: Appearances of Jane Austen in Contemporary Political Discourse"
- Susan Morgan, Miami University: "Temporal Connections: A Victorian Governess and Thailand in World War II"

11D: Dusty Threads from Famous Closets: Recovering Minor Works by Major Authors (Ballroom D)

Moderator: Jaqueline Grainger, Chawton House Library

- Morgan Richardson, University of Kentucky: "Revisiting the Arctic End: Mary Shelley's 'The Mortal Immortal'"
- Michelle Beissel Heath, Tulane University: "Redeeming 'the Uncroquetable Lawn': Charlotte Yonge, Flirtatious Hoops, and Family Time"
- Jessica Queener, West Virginia University: "'Opposing Forces': George Eliot and Periodical Authorship"

11E: Snapshots of Subjectivity (Lindquist Room)

Moderator: Deborah Manion, University of Iowa

- Marty Gould, University of South Florida: "*Jane Eyre*, Revisioned"
- Beth Shane, University of Iowa: "Charlotte Brontë's Scare Show: Gothic Spectacles in *Villette*"
- Mollie Barnes, University of Georgia: "Photographic Mourning: Amy Levy's *The Romance of a Shop* and the Development of Feminine Subjectivity"

11F: Transatlantic Connections (Johnson Room)

Moderator: Jessica DeSpain, Southern Illinois University Edwardsville

- Kay Puttock, Minnesota State University, Mankato: "Eagles in the Henhouse: Responses in the Life and Art of Christina Rossetti and Emily Dickinson to Victorian Views of Women"
- Anna Barker, University of Iowa: "'Casabianca': From Felicia Hemans's Romantic Heroism to Elizabeth Bishop's Enduring Love"
- Jessica DeSpain, Southern Illinois University Edwardsville: "From Plantation to Pamphlet: Victoria Press's Sociological Revision of Fanny Kemble's *Journal of a Residence on a Georgian Plantation*"

Dinner on your own: 5:00 p.m.-7:00 p.m.

Entertainment: 7:00 p.m.-9:00 p.m.—Old Capitol, Senate Chamber

"CELEBRATING VICTORIAN WOMEN'S LIVES: AN EVENING OF MUSIC AND RECITATIONS"
with "Hearing Voices," an introduction by Judith Pascoe, University of Iowa

Sponsored by The University of Iowa Division of Performing Arts and Arts Across Borders, the School of Music, and Prairie Lights Bookstore

SUNDAY, APRIL 5TH

BWWA Board Breakfast: 8:00 a.m.-9:30 a.m.—Lucas Board Room (Sheraton, Lower Level)

The cover illustration is from George W.M. Reynolds's *The Seamstress, or The White Slave of England* (1853) by Henry Anelay and the background design is by William Morris.

ACKNOWLEDGMENTS

First and foremost, we want to thank our industrious, indispensable, indefatigable faculty advisor, Professor Teresa Mangum. The epitome of grace and tact, Teresa has been a role model for us throughout this process, and we simply could not have done this without her guidance. We are also grateful to Professors Florence Boos and Judith Pascoe, whose support and advice have been invaluable.

Many other individuals have voluntarily and generously given to this conference, and we would particularly like to thank Pam Corpron Parker and the British Women Writers Association; Professors Florence Boos and Judith Pascoe from the Department of English, both of whom will be speaking this weekend; Professors Eric Gidal and Teresa Mangum, who aided in reviewing abstracts; Kelly Flinn from the Center for Conferences, whose exhaustive knowledge saved us from all kinds of missteps; Chairs Jon Wilcox and Claire Sponsler as well as Gayle Sand, Cherie Hansen-Rieskamp, and Erin Hackathorn from the Department of English; David Schoonover from Special Collections; Pamela White, Shalla Wilson, Kathrine Moermond, Melissa Hueiting, Deniz Martinek, and Margaret Anderson from Old Capitol Museum and The University of Iowa Museum of Art; Angie Baker, Kelly McDonald and Miten Negandhi from the Sheraton; Nicole Riehl from UI News Services; and past organizers of BWWC who fielded a variety of questions throughout the planning process. We also want to offer special recognition to the volunteers leading our Saturday Seminars: Professor Teresa Mangum, Joanne Janssen, Bridget Draxler and Jessica DeSpain; UI Professor Alvin Snider and Sarah Theobald-Hall from *Tulsa Studies in Women's Literature*; Professor Kevin Binfield, Angela Hatton, and Angela Walther from Murray State University; UI Professor Garrett Stewart; and Professor Donelle Ruwe from Northern Arizona University. We are also extraordinarily grateful to our graduate student volunteers.

Even with all of the individuals who have devoted their time and energy, this weekend would not have been possible without help from our generous contributors. We are deeply grateful for support from the following: Dean Linda Maxson for the College of Liberal Arts and Sciences' Perry A. and Helen Judy Bond Fund for Interdisciplinary Interaction; Associate Provost for Graduate Education and Graduate College Dean John Keller for a generous contribution from the Graduate College; Associate Provost and Dean Downing Thomas for generous support from International Programs; former and current Chairs of English, Professors Jon Wilcox and Claire Sponsler, and the Department of English; the Eighteenth- and Nineteenth-Century Interdisciplinary Colloquium; Director Pamela White and the staff members of Old Capitol Museum and The University of Iowa Museum of Art; Professor Garrett Stewart for his contribution from the Freedman Lecture Fund; Professor and Chair Leslie Schwalm and the Department of Women's Studies, Professor and Director Dorothy Johnson and the School of Art and Art History, and Professor and Chair Colin Gordon and the Department of History.

In addition to the conference itself, we have coordinated a special event to take place on Saturday evening called "Celebrating Victorian Women's Lives: An Evening of Music and Recitations." For this event, we would further like to thank Professor and Director Alan MacVey for an award from the Division of Performing Arts and Arts Across Borders; Professor Kristin Thelander and the School of Music; and Jan Weismiller and Prairie Lights Bookstore. This event was a major undertaking in its own right, and we are so thankful to Joanne Janssen, Laura Capp, Connie Winston, and Professors Meredith Alexander, Marian Wilson Kimber, Teresa Mangum, and Judith Pascoe for their efforts, which we will benefit from this Saturday.

Thanks, last but not least, to the British women writers who form the heart of this conference and to our guests who are devoted to them. This connection—not new, perhaps, but certainly still fresh—is obviously the reason we are here.

Gratefully,
 Laura Capp - - - - - Bridget Draxler - - - - - Lynne Nugent - - - - - Anna Stenson - - - - - LeDon Sweeney